

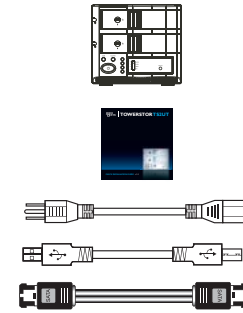

Package Contents

MS2C1/MS2U1/MS2T1.....	1
Manual	1
Power Cord	1
USB 2.0 Cable	1
eSATA Cable	1

(Please contact us in case of missing or damaged items)



Hardware Diagrams

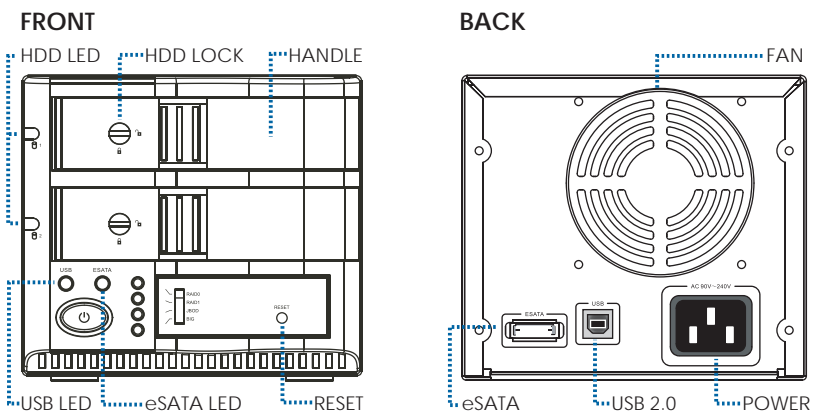

Installing a Hard Drive

Step 1
Turn the faceplate lock to the unlock position.

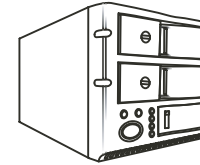

Step 3
Insert the hard drive with the connector towards the back.

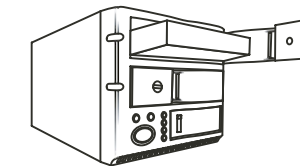

Step 2
Pull the faceplate handle to open the hard drive faceplate.

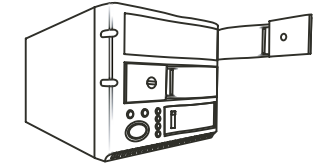

Step 4
Push the hard drive inwards while closing the faceplate. Turn the faceplate lock to the lock position.

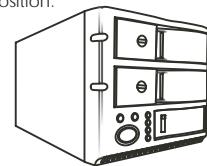

Note: Front panel hard drive handle lock position.

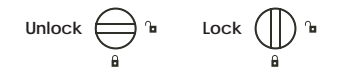

Setting the RAID Mode

Power on the unit. Set the unit to the desired RAID mode (RAID 0 / RAID 1 / JBOD / BIG) by adjusting the RAID switch located on the front panel, and select 'reset'.



Hardware Connections

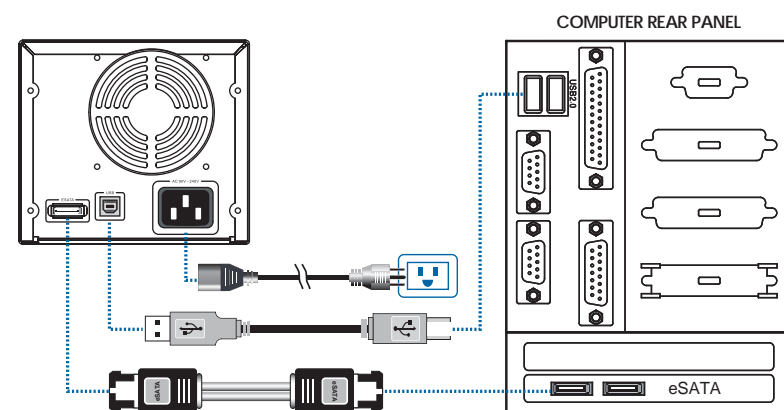

LED Indications

The front plate LED lights in a variation of blue, red, or purple depending on the unit's status.

BLUE	FLASHING RED & BLUE	LED OFF	PURPLE
HDD INSERTED	HDD FAILED	NO HARD DRIVE	ACCESSING DATA

RAID 1 LED Indications

FLASHING RED & BLUE	PURPLE	FLASHING RED & BLUE
HDD FAILED	REBUILD SOURCE	REBUILD TARGET

RAID Diagrams

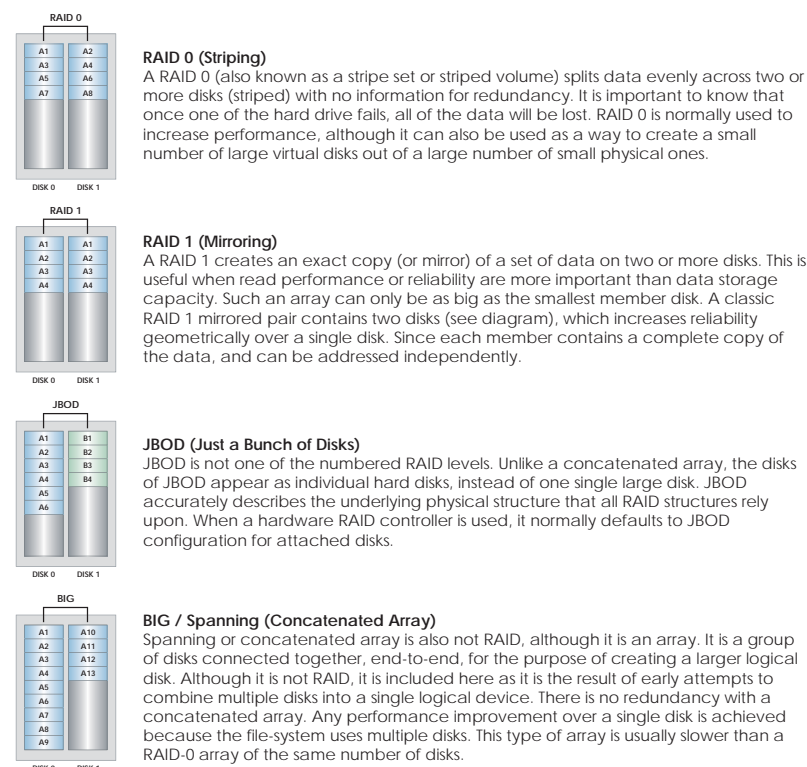

Other Sans Digital Products

- MS1UT**
 - 3.5" Hard Drive Enclosure with Removable Tray
 - Dual host interface: USB 2.0 and eSATA.
 - Supports high performance SATA hard drives.
 - Ultra quiet operation.
 - Vertical placement stand included.
 - Durable aluminum housing.
 - Both Mac OS X and Windows supported.
- MS2UT/MS2UB**
 - 2-Bay External RAID Enclosure
 - RAID design, supports RAID 0, 1.
 - eSATA and USB 2.0 (MS2UT) or Firewire 800 & USB 2.0 (MS2UB).
 - Drive interface: 3.5" x 2 SATA I/ SATA II hard drives.
 - Hot-swappable removable tray.
 - Data auto-rebuilding.
 - Hard disk, fan and temperature failure detectors.
- MS4B/MS4T/MS4UM**
 - 4-Bay External RAID Enclosure
 - Supports JBOD for independent access up to four hard drives.
 - 1394b x 2 (MS4B), eSATA x 4 (MS4T), USB 2.0 & Port Multiplier (MS4UM).
 - Drive interface: 4 x 3.5" SATA I/ SATA II hard drives.
 - RAID supported in MS4B (RAID 0) and MS4UM (software RAID 0, 1, 0+1, 5, 5 + spare in Windows).
 - OS independent with plug and play capability.
- MR5S1/MR5CT1**
 - 5-Bay External RAID 6 Enclosure
 - Hardware RAID design, supports RAID 0, 1, 0+1, 3, 5, 6, JBOD & hot spare disk.
 - SCSI Ultra 320 (MR5S1)/ USB 2.0, Firewire 800 & eSATA (MR5CT1).
 - Drive interface: 5 x 3.5" SATA I / SATA II hard drives.
 - Hot-swappable tray design.
 - Hard disk, fan and temperature failure detectors.

T: 1.800.980.1988 F: 1.562.949.3328 E: INFO@SANSDIGITAL.COM W: WWW.SANSDIGITAL.COM